

# MUNDIAL

## INDUSTRIAL PLUGS AND SOCKETS

Description: IP44 STRAIGHT FLUSH-FIT PLUG 2P+E 380V 16A 9H

Reference:

**03111**

### Characteristics:

Product type:	Low voltage straight flush-fit plug
Current:	16A
Poles:	2P+E
Voltage:	380/415 V
Frecuency(Hz):	-
Time code:	9
Colour:	Red
Weight (kg):	0,09
Dimensions:	
Materials:	Halogen-free plastic materials. Plastic parts: polyamide 6. Contacts: copper-zinc alloy
Packaging units:	10

### Technical data:

Degree of protection:	IP44
Degree of protection remarks:	
Resistance to impact:	IK08
Glow wire resistance:	960 °C
Ball pressure test:	125 °C
Ambient temperature range:	-25 °C / +40 °C

### Certifications and norms:

Directive:	2014/35/EU
Standards:	IEC 60309-1-2
Certificates:	



### Codes:

EAN:	8431044031118
Customs tariff number:	85.36.69.90
ETIM 8.0:	EC001319

# MUNDIAL

## INDUSTRIAL PLUGS AND SOCKETS

Description: IP44 STRAIGHT FLUSH-FIT PLUG 2P+E 380V 16A 9H

Reference: 03111

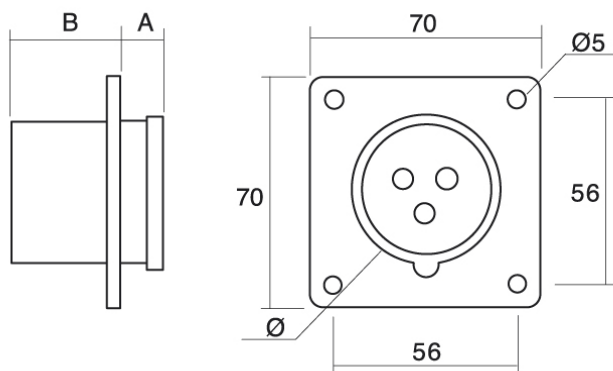

The colour of the picture does not match the actual image.

### Dimensions:

I	Poles	Dimensions		
		A	B	Ø
16 A	2P+E	21	42	43
	3P+E	21	42	45
	3P+N+E	20	42	55
32A	2P+E	21	51	55
	3P+E	21	51	55
	3P+N+E	21	51	55

### Sustainability:

RoHS - REACH

### Product end of life stage:

Product concerned in the WEEE regulations.

### Supply:

Supplied in a single box per packaging multiple